

- PROPOSED SW DRAINAGE
- PROPOSED SW MANHOLE
- SW RODDING EYE
- ROAD GULLY
- LINEAR CHANNEL
- RAIN WATER PIPE
- PROPOSED FW DRAINAGE
- PROPOSED MANHOLE
- PROPOSED WATER MAIN
- FULL RETENTION OIL INTERCEPTOR

NOTES

1. DRAINAGE DRAWING IS INDICATIVE ONLY AND SHOULD NOT BE USED FOR DETAILED DESIGN.
2. THE EIRGRID SUBSTATION IS BASED ON THE LATEST EIRGRID STANDARD (XDN-LAY-ELV-STND-H-001-R08 AS OF 04/02/2021).
3. THE EQUIPMENT LAYOUTS ARE INDICATIVE AND DIMENSIONS MAY CHANGE ONCE THE EXACT SPECIFICATIONS ARE DETERMINED.
4. ATTENUATION REQUIREMENTS TO BE DETERMINED AT DETAILED DESIGN STAGE.

ISSUE/REVISION

NO.	DATE	DESCRIPTION
P5	20.11.23	FOR PLANNING
P4	03.11.23	REVISED LAYOUT
P3	22.09.23	REVISED LAYOUT
P2	07.11.22	CLIENT COMMENTS
P1	28/10/22	CLIENT COMMENTS
P0	10.10.22	FIRST ISSUE FOR PLANNING
I/R	DATE	DESCRIPTION

STATUS

FOR PLANNING

PROJECT NUMBER 60657534 SCALE 1:250 @ A1

SHEET TITLE FIELDSTOWN DRAINAGE LAYOUT

SHEET NUMBER 60657534-ACM-DWG-FT-609 REV P5

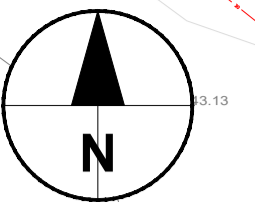
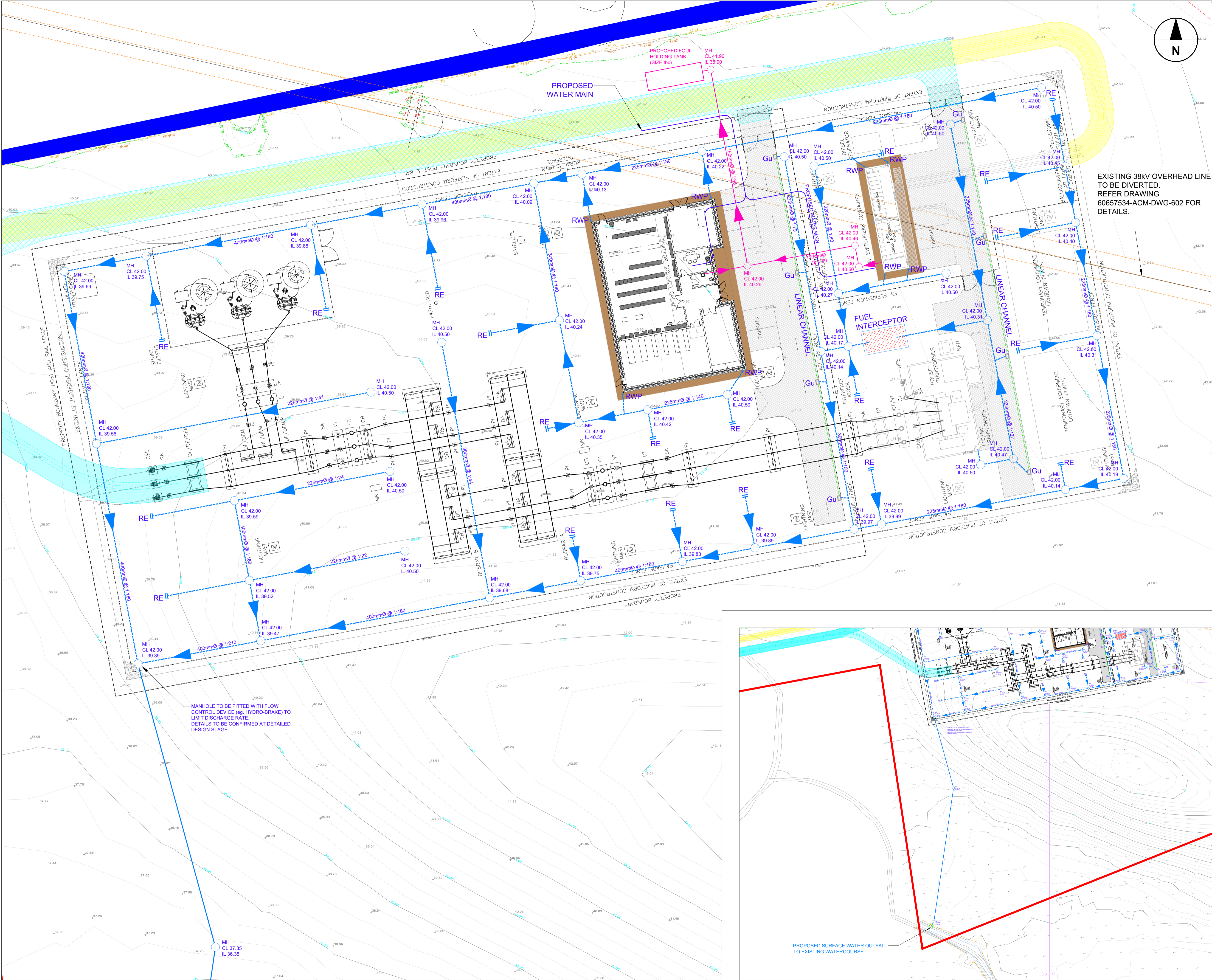

Last saved by: BERNICE CAHILL (2023-11-03) Last Plotted: 2023-11-20
 Filename: \\NA.AECOM\NET\COMPLFS\MEAD\UB\IN\EBLZLEGGAC\FIELD\2FP001\DATA\DCS\PROJECTS\BP\60657534_SUMMERHILL\FIELDSTOWN\1900_CAD_GIS\910_CAD\FIELDSTOWN\PLANNING FOLDER\60657534-ACM-DWG-609\DWG-609.dwg Management initials : Designer : GMBE Checked : KMCD Approved : BW
 Printed on % Post-Consumer Recycled Content Paper

This drawing has been prepared for the use of AECOM's client. It may not be used, modified, reproduced or relied upon by third parties, except as agreed by law. AECOM accepts no responsibility, and denies any liability, whatsoever, to any party that uses or relies on this drawing without AECOM's express written consent. Do not scale this document. All measurements must be obtained from the stated dimensions.