

- POST AND RAIL FENCE
- PALISADE FENCE
- PROPOSED EIRGRID EQUIPMENT
- PROPOSED CUSTOMER EQUIPMENT
- COMPOUND ROAD
- FOOTPATH

1. DRAWINGS ARE INDICATIVE ONLY AND SHOULD NOT BE USED FOR DETAILED DESIGN;
2. THE EIRGRID SUBSTATION IS BASED ON THE LATEST EIRGRID STANDARDS (XDN-LAY-ELV-STND-H-001-R08 AS OF 04/02/2021 & XDN-LAY-ELV-STND-H-006-R00 AS OF 13/02/2019);
3. THE EQUIPMENT LAYOUTS ARE INDICATIVE AND DIMENSIONS MAY CHANGE ONCE THE EXACT SPECIFICATIONS ARE DETERMINED;

NO.	DATE	DESCRIPTION
P5	31/10/2023	UPDATED CLIENT FEEDBACK
P4	13/10/2023	UPDATE FOR EIRGRID REVIEW
P3	27/09/2023	SHUNT FILTER ADDED
P2	28/10/2022	CLIENT COMMENTS
P1	10/10/2022	CLIENT COMMENTS
P0	30/09/2022	FIRST ISSUE FOR PLANNING
I/R	DATE	DESCRIPTION

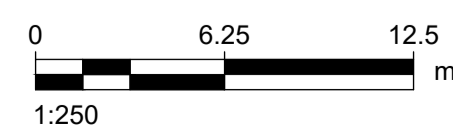
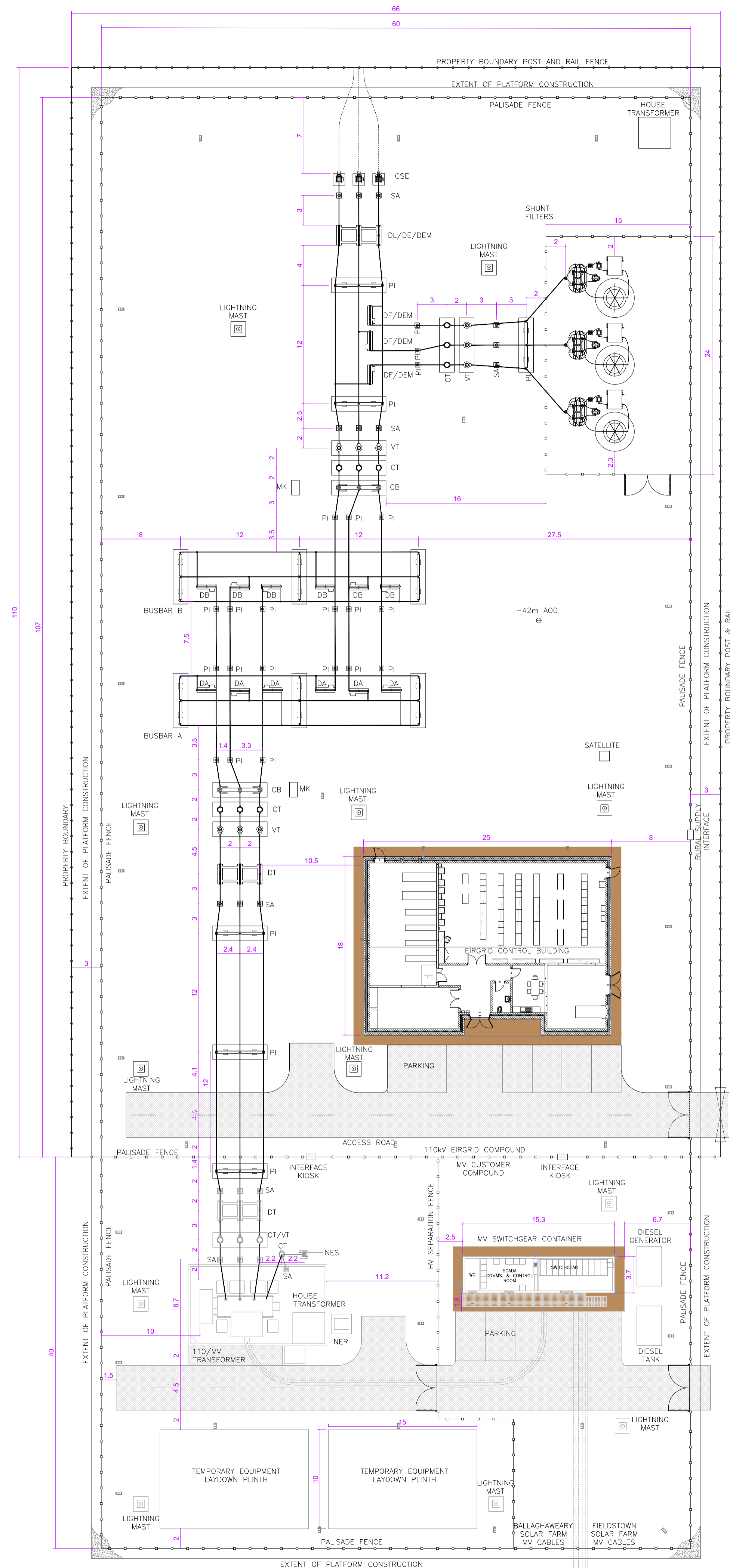
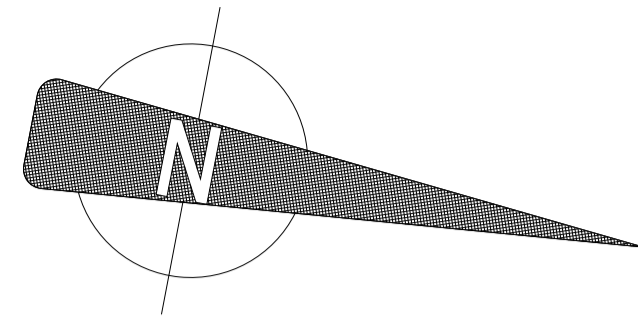

This drawing has been prepared for the use of AECOM's client. It may not be used, modified, reproduced or relied upon by third parties, except as agreed by AECOM or as required by law. AECOM accepts no responsibility, and denies any liability, whatsoever, to any party that uses or relies on this drawing without AECOM's express written consent. Do not scale this document. All measurements must be obtained from the stated dimensions.